



COUPLING RELAY, AC-3 5,5KW/400 V, 1 NO,
DC 24 V, 0.7...1.25*US, W.DIODE 3-POLE,
SIZE S00, SCREW CONNECTION

General technical data:

product brand name		SIRIUS
Size of contactor		S00
Protection class IP / on the front		IP20
Degree of pollution		3
Installation altitude / at height above sea level / maximum	m	2,000
Ambient temperature		
• during operation	°C	-25 ... +60
Mechanical service life (switching cycles)		
• of the contactor / typical		30,000,000

Main circuit:

Number of NC contacts / for main contacts		0
Number of NO contacts / for main contacts		3
Operating current		
• at AC-1 / up to 690 V		
• at ambient temperature 40 °C / Rated value	A	22
• at ambient temperature 60 °C / Rated value	A	20
• at AC-3 / at 400 V / Rated value	A	12
• at AC-4 / at 400 V / Rated value	A	8.5
Operating current		

<ul style="list-style-type: none"> • with 1 current path / at DC-1 <ul style="list-style-type: none"> • at 24 V / Rated value • at 110 V / Rated value • with 2 current paths in series / at DC-1 <ul style="list-style-type: none"> • at 24 V / Rated value • at 110 V / Rated value • with 3 current paths in series / at DC-1 <ul style="list-style-type: none"> • at 24 V / Rated value • at 110 V / Rated value 	A	20
	A	2.1
	A	20
	A	12
	A	20
	A	20
Operating current		
<ul style="list-style-type: none"> • with 1 current path / at DC-3 / at DC-5 <ul style="list-style-type: none"> • at 24 V / Rated value • at 110 V / Rated value • with 2 current paths in series / at DC-3 / at DC-5 <ul style="list-style-type: none"> • at 24 V / Rated value • at 110 V / Rated value • with 3 current paths in series / at DC-3 / at DC-5 <ul style="list-style-type: none"> • at 24 V / Rated value • at 110 V / Rated value 	A	20
	A	0.15
	A	20
	A	0.35
	A	20
	A	20
Operating power		
<ul style="list-style-type: none"> • at AC-1 <ul style="list-style-type: none"> • at 400 V / Rated value • at AC-2 <ul style="list-style-type: none"> • at 400 V / Rated value • at AC-3 <ul style="list-style-type: none"> • at 400 V / Rated value • at 500 V / Rated value • at 690 V / Rated value • at AC-4 <ul style="list-style-type: none"> • at 400 V / Rated value 	kW	13
	kW	5.5
	kW	5.5
	kW	5.5
	W	4,000
Active power loss / at AC-3 / at 400 V / for rated value of the operating current / per conductor	W	1.24

Control circuit/ Control:		
Design of the surge suppressor		with diode
Type of voltage / of the control supply voltage		DC
Control supply voltage <ul style="list-style-type: none"> • for DC / Rated value 	V	24
Operating range factor control supply voltage rated value / of the magnet coil <ul style="list-style-type: none"> • for DC 		0.7 ... 1.25

Closing power / of the magnet coil / for DC	W	2.3
Holding power / of the magnet coil / for DC	W	2.3

Auxiliary circuit:

Contact reliability / of the auxiliary contacts		1 faulty switching per 100 million (17 V, 1 mA)
Number of NC contacts / for auxiliary contacts / instantaneous contact		0
Number of NO contacts / for auxiliary contacts / instantaneous contact		1
Operating current <ul style="list-style-type: none"> • at AC-12 / maximum • at AC-15 <ul style="list-style-type: none"> • at 230 V / Rated value • at 400 V / Rated value 	A A A	10 6 3
Operating current / at DC-12 <ul style="list-style-type: none"> • at 60 V / Rated value • at 110 V / Rated value • at 220 V / Rated value 	A A A	6 3 1
Operating current / at DC-13 <ul style="list-style-type: none"> • at 24 V / Rated value • at 60 V / Rated value • at 110 V / Rated value • at 220 V / Rated value 	A A A A	10 2 1 0.3

Short-circuit:

Design of the fuse link <ul style="list-style-type: none"> • for short-circuit protection of the auxiliary switch / required • for short-circuit protection of the main circuit <ul style="list-style-type: none"> • with type of assignment 1 / required • with type of assignment 2 / required 		fuse gL/gG: 10 A fuse gL/gG: 35 A fuse gL/gG: 20 A
---	--	--

Installation/ mounting/ dimensions:

Mounting type		screw and snap-on mounting onto 35 mm standard mounting rail according to DIN EN 50022
Mounting type / Side-by-side mounting		Yes
Width	mm	45
Height	mm	57.5
Depth	mm	72
Spacing required / for grounded parts	mm	6

Connections/ terminals:

Design of the electrical connection		
--	--	--

<ul style="list-style-type: none"> • for main current circuit • for auxiliary and control current circuit 		screw-type terminals screw-type terminals
Type of connectable conductor cross-section		
<ul style="list-style-type: none"> • for main contacts <ul style="list-style-type: none"> • solid • finely stranded <ul style="list-style-type: none"> • with core end processing • for AWG conductors / for main contacts • for auxiliary contacts <ul style="list-style-type: none"> • solid • finely stranded <ul style="list-style-type: none"> • with core end processing • for AWG conductors / for auxiliary contacts 		2x (0.5 ... 1.5 mm ²), 2x (0.75 ... 2.5 mm ²), max. 2x (0.75 ... 4 mm ²) 2x (0.5 ... 1.5 mm ²), 2x (0.75 ... 2.5 mm ²) 2x (20 ... 16), 2x (18 ... 14), 1x 12 2x (0.5 ... 1.5 mm ²), 2x (0.75 ... 2.5 mm ²), max. 2x (0.75 ... 4 mm ²) 2x (0.5 ... 1.5 mm ²), 2x (0.75 ... 2.5 mm ²) 2x (20 ... 16), 2x (18 ... 14), 1x 12

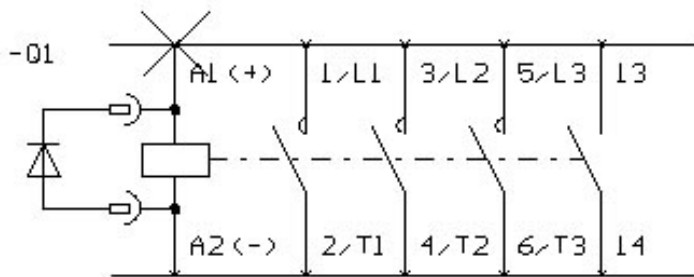
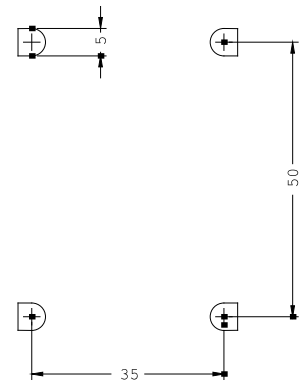
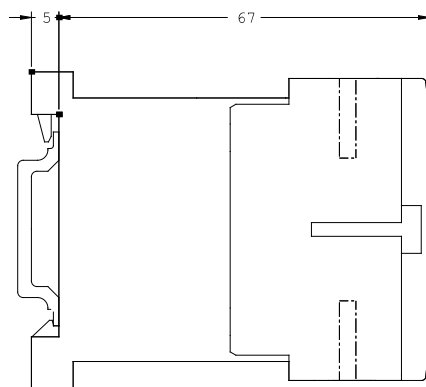
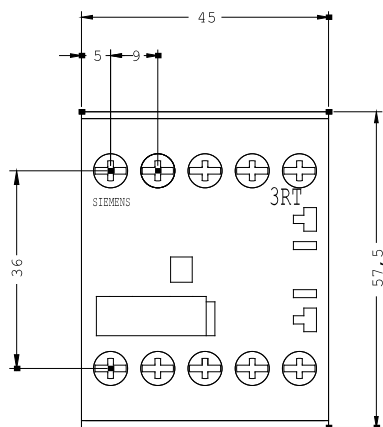

last change:

Dec 6, 2014