

# SIEMENS

## Product data sheet

**3RV1021-1DA10**



Abb. ähnlich / similar picture

CIRCUIT-BREAKER SIZE S0,  
FOR MOTOR PROTECTION, CLASS 10,  
A-REL. 2.2...3.2A, N-REL.42A,  
SCREW TERMINAL,  
STANDARD SWITCHING CAPACITY

### General technical details:

Continuous current / rated value	3.2 A
Adjustable response current	
• of the non-delayed short-circuit release	
• initial value	42 A
• final value	42 A
• of the current-dependent overload release	
• initial value	2.2 A
• final value	3.2 A
Switch-off capacity limit short-circuit current / at 400 V / rated value	100 kA
Type of voltage	AC/DC
Service power	
• at AC-3 / at 400 V / rated value	1.1 kW
• for three-phase servomotors / rated value	1.1 kW
Number of poles	3
Number of NC contacts / for auxiliary contact	0
Number of NO contacts / for auxiliary contact	0
Number of change-over switches / for auxiliary contact	0

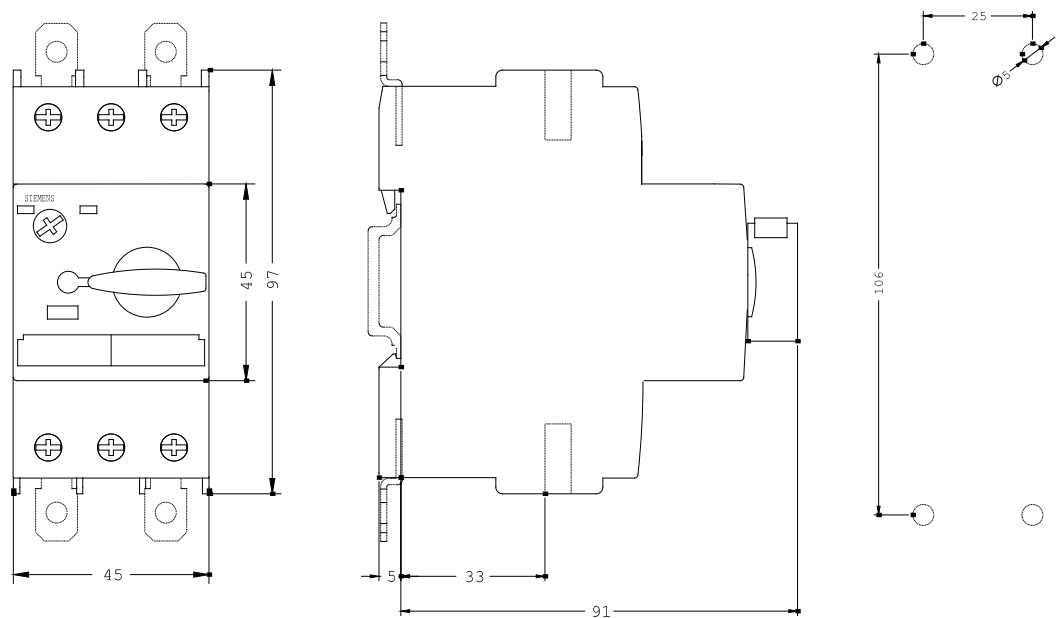
Trip class	CLASS 10
Product function / Overload protection	Yes
Mechanical design:	
Design of the electrical connection / for main current circuit	screw-type terminals
Type of fixing/fixation	screw and snap-on mounting onto 35 mm standard mounting rail according to DIN EN 50022
Product component / auxiliary switch	No
Size of the circuit-breaker	S0
Ambient conditions:	
Protection class IP	IP20



last change:

11/02/2006