



Figure similar

CIRCUIT-BREAKER, SIZE S0, FOR MOTOR PROTECTION, CLASS 10, WITH OVERLOAD RELAY FUNCTION A REL.4.5A...6.3A, N REL.82A, SCREW CONNECTION, STANDARD BREAKING CAPACITY

product brand name		SIRIUS
Product designation		circuit breaker
Design of the product		for motor protection with overload relay function

General technical data:		
Active power loss total typical	W	6
Shock resistance		25g / 11 ms
Surge voltage resistance Rated value	V	6 000
Mechanical service life (switching cycles) <ul style="list-style-type: none">• of the main contacts typical		100 000
Protection class IP <ul style="list-style-type: none">• on the front		IP20
Equipment marking <ul style="list-style-type: none">• acc. to DIN EN 61346-2		Q

Main circuit:		
Number of poles for main current circuit		3
Adjustable response value current of the current-dependent overload release	A	4.5 ... 6.3
Operating voltage <ul style="list-style-type: none">• Rated value• at AC-3 Rated value maximum	V V	690 690
Operating current <ul style="list-style-type: none">• at AC-3— at 400 V Rated value	A	6.3
Operating power <ul style="list-style-type: none">• at AC-3		

— at 400 V Rated value	kW	2.2
Operating frequency		
• at AC-3 maximum	1/h	15
Auxiliary circuit:		
Number of CO contacts		
• for auxiliary contacts		0
Product expansion Auxiliary switch		Yes
Protective and monitoring functions:		
Trip class		CLASS 10
Maximum short-circuit current breaking capacity (Icu)		
• with AC at 240 V Rated value	kA	100
• with AC at 400 V Rated value	kA	100
• with AC at 500 V Rated value	kA	100
• with AC at 690 V Rated value	kA	6
Short-circuit:		
Design of the overcurrent release and short-circuit release		thermomagnetic
Installation/ mounting/ dimensions:		
mounting position		any
Mounting type		screw and snap-on mounting onto 35 mm standard mounting rail according to DIN EN 50022
Height	mm	97
Width	mm	45
Depth	mm	96
Required spacing		
• with side-by-side mounting		
— Backwards	mm	0
— at the side	mm	0
Connections/ Terminals:		
Type of electrical connection		
• for main current circuit		screw-type terminals
• for auxiliary and control current circuit		screw-type terminals
Arrangement of electrical connectors for main current circuit		front side
Product function		
• removable terminal for auxiliary and control circuit		No
Type of connectable conductor cross-section		
• for main contacts		
— solid		2x (1 ... 2.5 mm ²), 2x (2.5 ... 6 mm ²)
— stranded		2x (1 ... 2.5 mm ²), 2x (2.5 ... 6 mm ²)

- finely stranded with core end processing
- for AWG conductors for main contacts

2x (1 ... 2.5 mm²), 2x (2.5 ... 6 mm²)
2x (14 ... 10)

Safety related data:

Protection against electrical shock

finger-safe

Mechanical data:

Size of the circuit-breaker

S0

Ambient conditions:

**Installation altitude at height above sea level
maximum**

m

2 000

Ambient temperature

- during operation
- during storage
- during transport

°C

-20 ... +60

°C

-50 ... +80

°C

-50 ... +80

Certificates/ approvals:

other

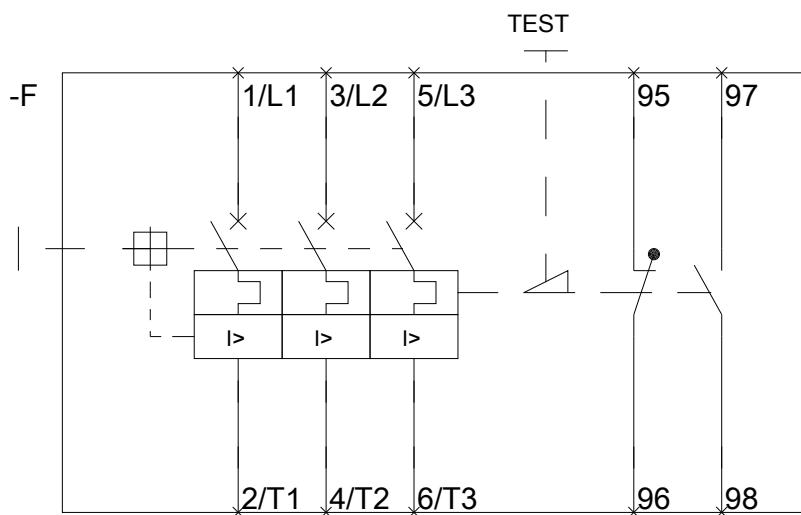
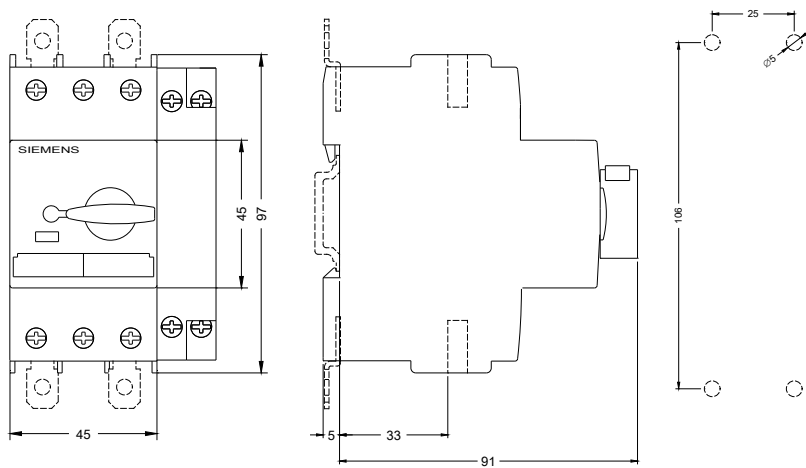

last modified:

11.03.2015